



# AirGo Smart Fan User Manual

Carefully read this instruction manual before  
switching on your AirGo Smart Fan for your  
utmost safety.



# IMPORTANT SAFEGUARDS

The fan is intended for household and indoor use only.

Ensure that the fan is switched off from the supply mains before removing the guard.

Children shall not play with the appliance.

Cleaning and user maintenance shall not be made by children without supervision.

This appliance can be used by children aged from 8 years and above and persons with reduced physical, sensory or mental capabilities or lack of experience and knowledge, if they have been given supervision or instruction concerning use of the appliance in a safe way and understand the hazards involved.

If the supply cord is damaged, it must be replaced by the manufacturer or its service agent or similarly qualified person in order to avoid hazard.

# CONTENTS

**Page 4-5** - Warnings and Cautions

**Page 6-7** - AirGo Smart Fan Assembly

**Page 8-9** - Operating Instructions

**Page 10** - Cleaning, Maintenance and Specifications

**Page 11** Cleaning, Maintenance and Storage

**Page 12** - Warranty

**Page 13-14** - Connect to the GeoSmartPro App



## What's in the box

- |  |                       |                   |
|--|-----------------------|-------------------|
| 1. Motor with control panel                | 4. Plastic grille nut | 7. Base           |
| 2. Front grille                            | 5. Blade              | 8. Base ring/ cap |
| 3. Back grille                             | 6. Blade cap          | 9. Pedestal bar   |
| 10. Four screws, four bolts, four washers. |                       |                   |

# WARNINGS

- This appliance can be used by children aged from 8 years and above and persons with reduced physical, sensory or mental capabilities or lack of experience and knowledge if they have been given supervision or instruction concerning use of the appliance in a safe way and understand the hazards involved.
- Ensure that the fan is switched off from the supply mains before removing the guard.
- If the supply cord is damaged, it must be replaced by the manufacturer, its service agent or similarly qualified persons in order to avoid a hazard.
- Never place the fan near any gas appliances, fire or flammable liquids.
- Never hit or shake the fan to prevent damage.
- Never cover or obstruct the air inlet or outlet to prevent overheating.
- Never spray water or place the fan near water to prevent electric shock.
- Make sure to have a professional technician, manufacturer or a service agent to replace a damaged power cord.
- Never share the power outlet with other appliances.
- Never connect or disconnect the power plug with wet hands to avoid electric shocks.
- Never put rods or objects into the opening of the unit.
- Never use an extension cord.

# CAUTIONS

- Be sure the fan is placed on a stable surface when operating to avoid overturning.
- The fan must not be used if the guards are not fastened according to instructions.
- The appliance is for indoor use only.
- Do not plug into the power socket before installation is complete.
- Never insert fingers, pencils, or any other object through the guard when fan is running.
- Power plug must be removed from power socket before cleaning, servicing, maintenance and move from one location to another.
- The fan should not be placed in a damp place or where humidity is high (such as a bathroom).
- Keep the unit at least 1 metre away from electric appliances such as TV's and radios, to avoid electromagnetic interference.
- Do not expose the unit under direct sunlight to avoid surface colour fading.
- Do not tilt the unit for more than 35 degrees or upside down while transporting.
- Place the unit on a flat surface with less than 5 degree inclination.
- Do not use chemical solvents (i.e. Benzene, alcohol-grazer) to clean the unit surface to avoid scratching and damaging the surface.
- Do not use your appliance with an extension cord unless it has been checked and tested by a qualified electrician or electrical supplier.
- Children should be supervised to ensure that they do not play with the appliance.

# AIRGO SMART FAN ASSEMBLY

1. Assemble the tube on the base by tightening the four screws and inserting the base ring down over the round base.

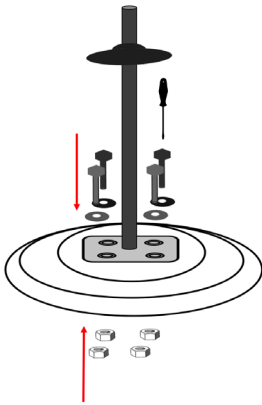

2. The height of the fan can be adjusted by loosening the height adjustment ring. Raise or lower the fan and carefully tighten the screw.

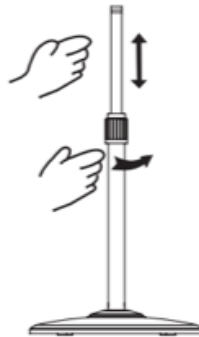

3. Insert the fan body in the main tube and tighten the screw to secure the connection tube.



# AIRGO SMART FAN ASSEMBLY

- 4.** Loosen the nut **(5)** of the motor **(8)**. Firmly mount the rear grille **(6)** on the motor by matching 3 mounting pads. Tighten the nut **(5)** on the back grid so as to block the grille against the motor.

Mount the fan blades **(4)** on the axis **(7)**. Firmly secure them with the reversed nut **(3)**. At this point, the blades should turn freely without touching the nut of the rear grille.

Loosen the locking strapping clip **(2a)** Put the front grille on the rear grille and tighten the locking screw.

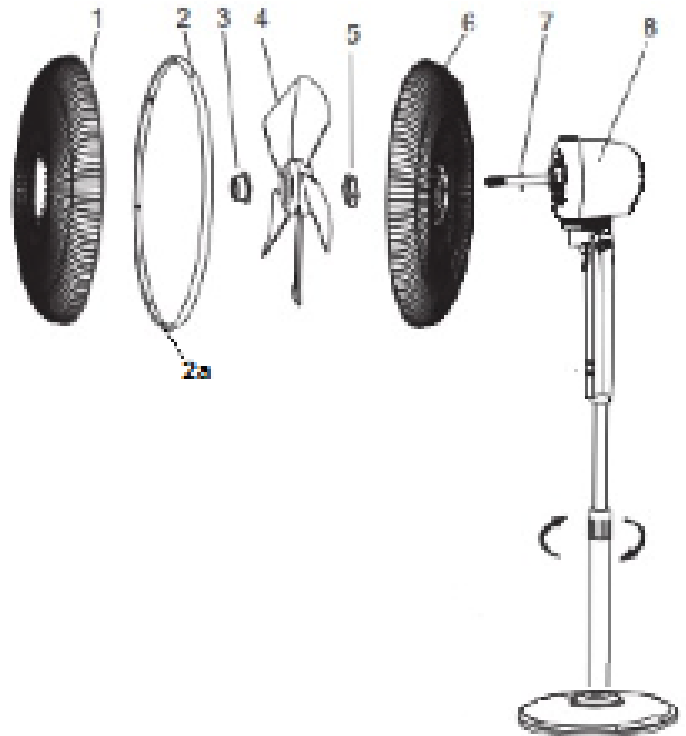

# OPERATING INSTRUCTIONS

**Warning:** Make sure the fan is fully assembled (and the grilles are in place and locked) before switching on. **All below functions can be carried out through the GeoSmartPro App.**

1. Place your fan on a level and dry surface.
2. Plug the fan into a mains socket of suitable voltage and frequency (see Technical Specifications for details)
3. Touch ON/OFF button to turn on the fan.
4. Choose the desired SPEED and MODE using the Control Panel or GeoSmartPro App.
5. Use the TIMER button to set the desired turn-off time from 1-8 hours
6. Use the SWING button to start or stop oscillation.
7. Tilt Adjustment: To adjust the tile, hold the Main Body with one hand, push the Motor Housing to the desired vertical position with the other hand.

**Caution:** The fan should be always be switched off when making this adjustment.

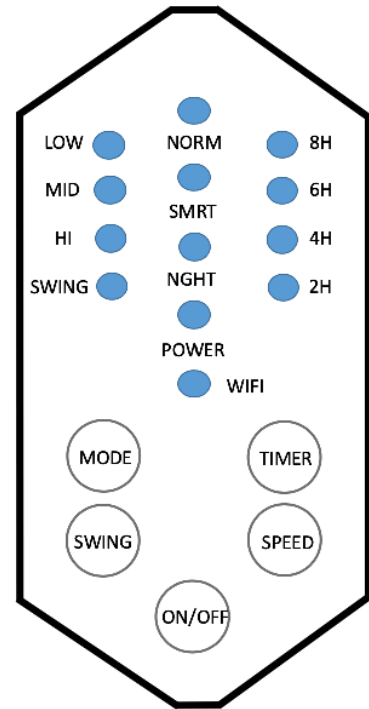

# OPERATING INSTRUCTIONS

## Swing:

Press the Swing button to turn on oscillation. The swing indicator turns on. Press again to turn off oscillation.

## Speed:

Press the Speed button to change fan speed. There are 3 possible speeds: **Low/Medium/High**. The corresponding indicator turns on.

## Mode:

**NORM mode:** The fan operates in the constant speed set using the Speed button.

**SMRT mode:** The unit simulates a natural breeze.

**NGHT mode:** The unit simulates a gentle breeze suitable for night-time use.

## Timer:

Press this button to set the turn-off delay for the unit. The turn-off delay can be set in two hour increments from 2 to 8 hours. There are 4 indicators **2H,4H,6H** and **8H**.

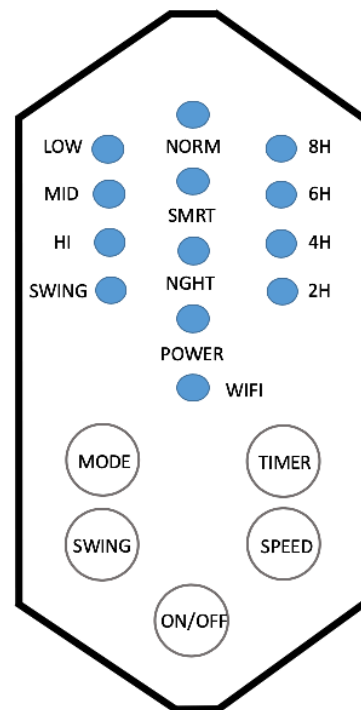

# CLEANING, MAINTENANCE AND SPECIFICATIONS

**Warning : Always unplug the appliance before cleaning.**

1. Always disconnect the appliance from the mains by switching it off and removing the plug from the power outlet before cleaning.
2. To clean the outer surface of the appliance, use a lightly damp cloth. Then, dry it thoroughly with a soft, dry cloth before using again.
3. Do not allow water to penetrate the motor during cleaning.
4. Do not reconnect the unit until it is completely dry.

## **Product Specifications**

**Model No.** -- AGF01UK

**Power supply** -- 220-240V ~ 50-60Hz

**Power** -- 55W

**Net weight** -- 5.6kg

**Gross weight** -- 6.5kg

**Gross dimension** --(W x H x D) 495\*230\*450 mm

**Warranty** -- 2 years

# CLEANING, MAINTENANCE AND STORAGE



## **Idea**

Your AirGo Smart Fan can also be used during the cold winter season to circulate warm air throughout your home.

**Warning : Always unplug the appliance before cleaning.**

### **Fan Blade Cleaning**

1. To access the fan blade, remove the front grille and blade cap.
2. Clean the fan blade, front and rear grilles with a soft moist cloth.
3. Place the fan blade back in its place, tighten the blade cap and securely fasten the front grille (see Assembly Instructions to ensure the fan blade, front and rear grilles are assembled properly).

### **Fan Head, Base and Pole Cleaning**

Using a soft, moist cloth with or without a mild soap solution carefully clean the fan base, pole and head. Please use caution around the motor housing area.

**Important: Do not allow the motor or other electrical components to be exposed to water.**

### **Fan Storage**

Your AirGo Smart Fan can be stored in the off season, either partially disassembled or assembled. It is important to keep it in a safe and dry location.

- If stored disassembled, we recommend using the original (or appropriately sized) box.
- If stored assembled or partially assembled, remember to protect the fan head from dust and to unplug it while not in use.

# WARRANTY

Please keep your receipt as this will be required for any claims under this warranty.

**AirGo Smart Fan's warranty is for 2 years from the date of purchase as described in this document.**

During this warranty period, if in the unlikely event the AirGo Smart Fan no longer functions due to a design or manufacturing fault, please take it back to the place of purchase, with your till receipt and a copy of this warranty.

The rights and benefits under this warranty are additional to your statutory rights, which are not affected by this warranty. Only GeoSmartPro Ltd. ("GeoSmartPro") has the right to change these terms.

GeoSmartPro undertakes within the warranty period to repair or replace the appliance, or any part of appliance found to be not working properly free of charge provided that:

- you promptly notify the place of purchase or GeoSmartPro Ltd. of the problem; and
- the appliance has not been altered in any way or subjected to damage, misuse, abuse, repair or alteration by a person other than a person authorised by GeoSmartPro Ltd.

Faults that occur through; improper use, damage, abuse, use with incorrect voltage, acts of nature, events beyond the control of GeoSmartPro, repair or alteration by a person other than a person authorised by GeoSmartPro or failure to follow instructions for use are not covered by this warranty. Additionally, normal wear and tear, including, but not limited to, minor discoloration and scratches are not covered by this warranty.

The rights under this warranty shall only apply to the original purchaser and shall not extend to commercial or communal use. If your appliance includes a country-specific warranty insert please refer to the terms and conditions of such warranty or contact your local authorised dealer for more information.

Waste electrical products should not be disposed of with Household waste.

Please recycle where facilities exist.

# CONNECT TO THE GEOSMARTPRO APP

1. Download the GeoSmartPro app from the App Store or Google Play.



2. **Registration:** Enter the register/login interface, input the phone number to receive a verification code to register by inputting your email address.

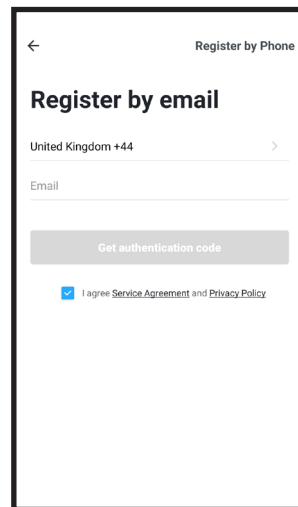

# CONNECT TO THE GEOSMARTPRO APP

## 3. Connection:

1. Preparation: Connect your AirGo fan to your electricity outlet, press the “on/off “ button and then the “mode” button for 5 seconds until the indicator rapidly blinks, then click on the confirm button.
2. You will then need to enter your wifi password to connect your phone the the wifi router and connect to the internet.
3. Once you’ve entered all the details, you should see a ‘Connecting’ page, where your phone will try to link up to your AirGo smart fan through the wifi network.
4. Wait until your configuration is successful, then tap ”Complete” & Enjoy your AirGo Smart Fan!

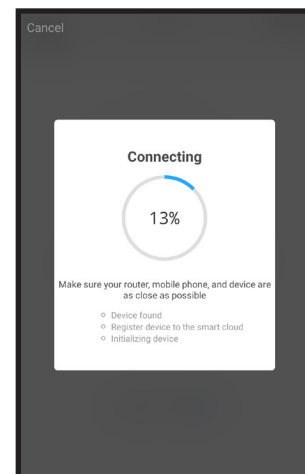
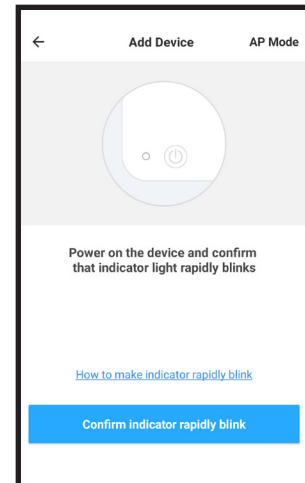

## **Information on the disposal for Waste Electrical & Electronic Equipment (WEEE).**

This symbol on the products and accompanying documents means that used electrical and electronic products should not be mixed with general household waste. For proper disposal for treatment, recovery and recycling, please take these products to designated collection points where they will be accepted on a free of charge basis. In some countries you may be able to return your products to your local retailer upon the purchase of a new product. Disposing of this product correctly will help you save valuable resources and prevent any possible effects on human health and the environment, which could otherwise arise from inappropriate waste handling. Please contact your local authority for further details of your nearest collection point for WEEE.

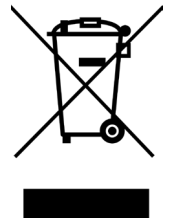

• • •

#### **ADDRESS**

GeoSmartPro Ltd, 1.70  
Watford Croxley, 1st Floor,  
Building 2, Croxley  
Business Park, Watford,  
Hertfordshire, WD18 8YA.

#### **ONLINE**

[www.geosmartpro.com](http://www.geosmartpro.com)  
[support@geosmartpro.com](mailto:support@geosmartpro.com)

• • •

